



UNM STUDENT HOUSING OPEN FORUM

SESSION V

9 . 23 . 2010

Planning Workshop: Part III



ACTION ITEM: REAL ESTATE
to be posted on website
still in development

PLANNING WORKSHOP

Workshop efforts to be applied to option A - G:

1. Define form and character of expanded core
recreational spaces
2. Delineate critical east/west
pedestrian connections
5. Discuss **vehicle circulation**,
entries and exits to campus

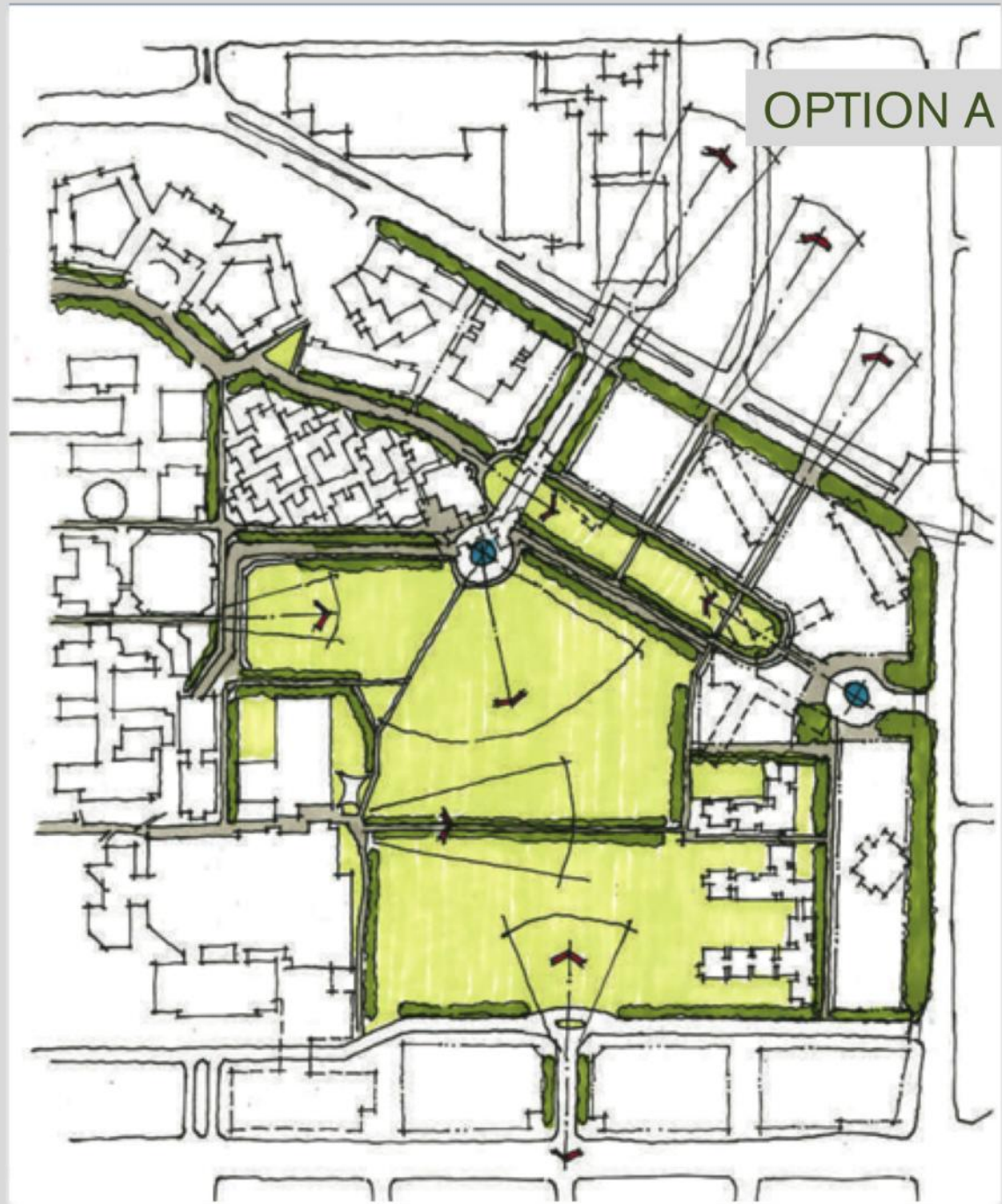



WORKSHOP CHALLENGE

Provide three ideas, which will improve the experience of our shared recreation spaces.

- Leave 1 or 2 tennis courts for use by students and neighbors
- Remove parking south of SRC
- Put majority of green space along perimeter to interact with neighbors
- Solve Southeast corner – not safe and/or welcoming
Create better access across Johnson Field
- Integrate gardens as usable exterior space
- Create a Frisbee golf course



- Create an area to stage an amphitheater for classes and entertainment
- Insert a variety of landscaped forms and features
- Create a marked perimeter running/walking path that links up with other paths on campus and surrounding region
- Replace the surrounding gravel path on Johnson with a better surface
- Create smaller scale open spaces like the interior courts of Hokona





WORKSHOP CHALLENGE

Provide three ideas for improving pedestrian circulation on campus.

- Include basic amenities to pedestrian paths like lightings
- Continue cooperation with city/regional bodies to help improve transportation
- On the Girard edge, create clear walkways that lead onto campus, put in better lighting, shade and improve sidewalk
- Soften pedestrian connection north of natatorium
- Improve scheduling of Upper and Lower Johnson field for better access
- Improve grading on Lower Johnson field
- Put shade onto lower Johnson Field





WORKSHOP CHALLENGE

Identify a single vehicular access point for each major street: Central, Girard & Campus.

OPTION A



PLANNING WORKSHOP

Workshop efforts to be applied to option A - G:

3. Outline physical characteristics of **campus perimeter**
4. Produce **architectural guidelines** for building

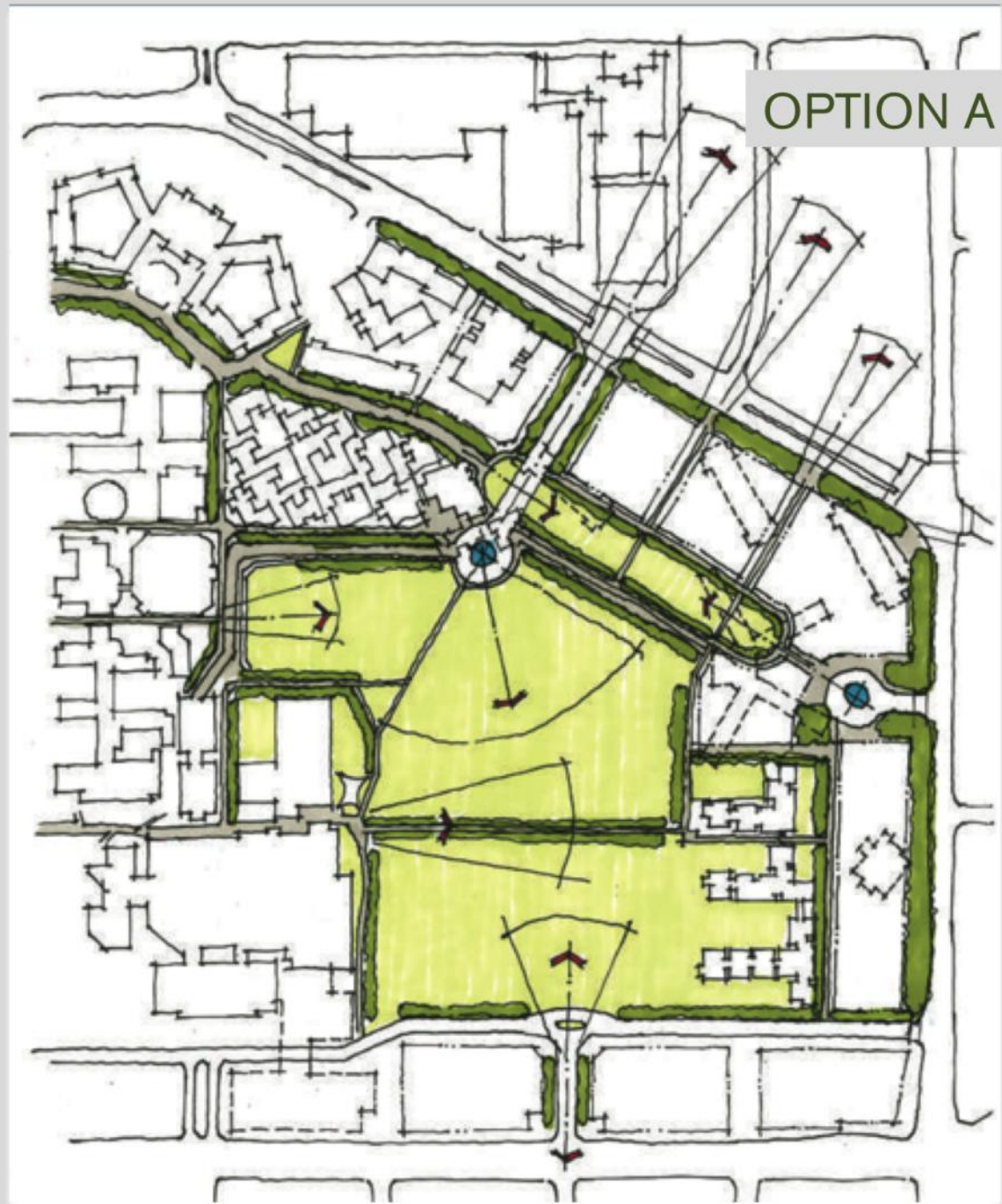



HIGH DENSITY – LOW RISE DORMS

Precedent: Highland District Housing, University of Arizona





HIGH DENSITY – LOW RISE DORMS

Precedent: Highland District Housing, University of Arizona





SITE SELECTION

What makes a good site?

OPTION B



B



WORKSHOP CHALLENGE

- Suggest a site for the first residential hall
- Layout expanded recreation areas
- Locate neighborhood services

Thursday 4:00p-6:00p
Student Union Building
Forum Location:
SUB venue to vary
between Lobo A/B
& Plaza Atrium

**CENTRAL CAMPUS STUDENT HOUSING
OPEN FORUM SCHEDULE****Session I: August 26**

Lobo A/B

1. Action Items Report
2. Central Campus Planning Criteria

Session II: September 2

Lobo A/B

1. Action Items Report: Making a Residential Community @ UNM
2. Plan Concepts Progress Work

Session III: September 9

SUB Plaza Atrium

1. Action Items Report: Transportation & Parking Opportunities @ UNM
2. Planning Workshop: PART I

Session IV: September 16

Plaza Atrium

1. Action Items Report: Recreation on UNM's Central Campus
2. Planning Workshop: PART II

Session V: September 23

SUB Plaza Atrium

1. Action Items Report: Real Estate Data for UNM Community
2. Planning Workshop: PART III

Session VI: September 30

SUB Plaza Atrium

Central Campus Housing Plan:
Phase One Site Selection

Session VII: October 7

Lobo A/B

Phase One Site Development: Challenges
& Opportunities

FALL BREAK: October 14**Session VIII: October 21**

SUB Plaza Atrium

1. Central Campus Housing Plan
2. Central Campus Development Schedule
3. Next Steps w/ American Campus Community